

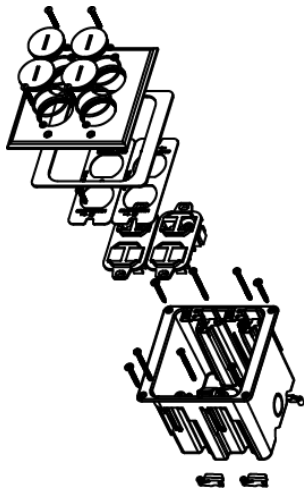

Wiremold  
WMFB2KS8B Series Dual-Gang Floor Box Assembly  
Part No. WMFB2KS8B



Includes dual-gang box, two 106 adapter with eight openings for communication devices, and brass cover with four screw plugs. For hole cut dimensions, see installation instructions sheet. Box Dimensions: 3 1/4" W x 3 3/4" L x 3 7/8" D (83mm W x 95mm L x 98mm D) Device Plate: 4 7/8" W x 5 1/16" L (124mm W x 129mm L).

## Features & Benefits

Includes dual-gang box, two 106 adapter with eight openings for communication devices, and brass cover with four screw plugs. For hole cut dimensions, see installation instructions sheet. Box Dimensions: 3 1/4" W x 3 3/4" L x 3 7/8" D (83mm W x 95mm L x 98mm D) Device Plate: 4 7/8" W x 5 1/16" L (124mm W x 129mm L).

## Specifications

### General Info

Product Line	Wiremold	UPC Number	786564054047
Country Of Origin	China	Construction	Not Assembled
Application Sector	Residential/Commercial	Standard	cULus Listed Nonmetallic Outlet Boxes: File E143222 Guide QCMZ. Meets Article 314.27(C) of NEC.
Type	Floor Box		

### Dimensions

Product Width US	3.25 in	Product Depth US	3.875 in
------------------	---------	------------------	----------

### Listing Agencies / 3rd Party Agencies

cULus ListingNumber	E143222	cULus Listed	Yes
---------------------	---------	--------------	-----

### Additional Information

RoHS Conformant	Yes
-----------------	-----

---

Technical Information

---

Cable Entry	Through Floor
-------------	---------------

---